

ROOM DIMENSIONS AND SEATING CAPACITY — FIFTH FLOOR

| Room Name | Square Feet | Dimensions | Height | Pod | Theater | Reception | Classroom | U-Shape | H-Square | Conference |
|------------------|-------------|------------|--------|-----|---------|-----------|-----------|---------|----------|------------|
| BOSTON COMMON | 675 | 25' x 27' | 8'1" | 20 | 25 | 35 | 24 | 14 | 20 | 16 |
| PUBLIC GARDEN | 1,276 | 29' x 44' | 8'1" | 36 | 90 | 80 | 64 | 32 | 38 | 24 |
| THE FENS | 1,276 | 29' x 44' | 8'1" | 36 | 90 | 80 | 64 | 32 | 38 | 24 |
| RIVERWAY | 1,276 | 29' x 44' | 8'1" | 36 | 90 | 80 | 64 | 32 | 38 | 24 |
| OLMDSTED | 520 | 26' x 20' | 8'1" | 10 | 25 | 35 | 15 | 15 | 16 | 12 |
| JAMAICA POND | 720 | 36' x 20' | 8'1" | 18 | 35 | 40 | 25 | 22 | 24 | 14 |
| ARNOLD ARBORETUM | 640 | 32' x 20' | 8'1" | 18 | 35 | 40 | 20 | 20 | 22 | 14 |
| FRANKLIN | 288 | 12' x 24' | 8'1" | — | — | — | — | — | — | 10 |
| FOREST HILLS | 448 | 28' x 16' | 8'1" | — | — | — | — | — | — | 14 |

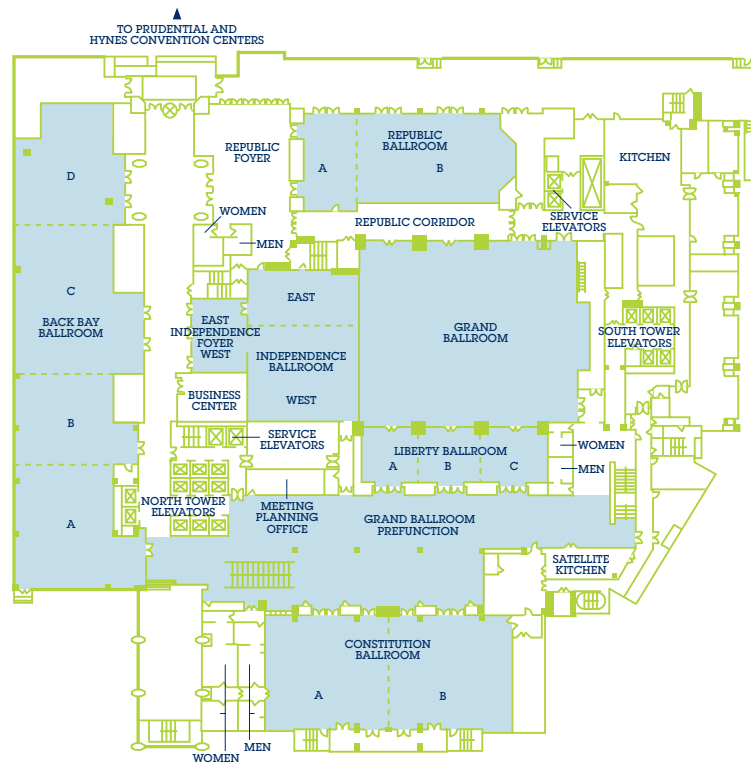

ROOM DIMENSIONS AND SEATING CAPACITY — SECOND FLOOR

| Room Name | Square Feet | Dimensions | Height | Rounds of 10 | Theater | Conference | Reception | Classroom | U-Shape |
|--|-------------|-------------|--------|--------------|---------|------------|-----------|-----------|---------|
| INDEPENDENCE FOYER | 780 | 35' X 24' | — | — | — | — | — | — | — |
| INDEPENDENCE FOYER EAST | 306 | 10' X 24' | — | — | — | — | — | — | — |
| INDEPENDENCE FOYER WEST | 551 | 25' X 24' | — | — | — | — | — | — | — |
| INDEPENDENCE EAST/WEST & FOYER EAST/WEST | 4,490 | 75' X 72' | 12' | 300 | 370 | — | 400 | 200 | — |
| INDEPENDENCE WEST & FOYER WEST | 2,923 | 49' X 72' | 12' | 200 | 220 | 36 | 260 | 115 | 46 |
| INDEPENDENCE EAST & FOYER EAST | 1,567 | 26' X 72' | 12' | 80 | 120 | 36 | 140 | 60 | 38 |
| INDEPENDENCE BALLROOM | 3,635 | 75' X 48' | 12' | 300 | 370 | 60 | 400 | 200 | 70 |
| INDEPENDENCE EAST | 1,261 | 26' X 48' | 12' | 80 | 120 | 36 | 140 | 60 | 38 |
| INDEPENDENCE WEST | 2,372 | 49' X 48' | 12' | 200 | 220 | 36 | 260 | 115 | 46 |
| LIBERTY BALLROOM | 2,441 | 89' X 27' | 23' | 180 | 217 | — | 240 | 125 | — |
| LIBERTY AB | 1,560 | 60' X 26' | 12' | 120 | 120 | 50 | 160 | 68 | 42 |
| LIBERTY BC | 1,627 | 97' X 42' | 12' | 120 | 120 | 52 | 160 | 68 | 42 |
| LIBERTY A | 773 | 28' X 28' | 23' | 60 | 60 | 24 | 80 | 34 | 26 |
| LIBERTY B | 787 | 30' X 28' | 23' | 60 | 60 | 25 | 80 | 34 | 26 |
| LIBERTY C | 840 | 30' X 26' | 23' | 60 | 60 | 26 | 80 | 34 | 26 |
| REPUBLIC BALLROOM | 4,117 | 105' X 48' | 14' | 360 | 415 | — | 600 | 250 | — |
| REPUBLIC A | 1,150 | 25' X 48' | 14' | 80 | 100 | 30 | 100 | 60 | 38 |
| REPUBLIC B | 2,967 | 68' X 42' | 14' | 240 | 300 | 60 | 400 | 175 | 62 |
| BACK BAY BALLROOM | 10,141 | 238' X 61' | 11' | 870 | 1,034 | — | 1,500 | 500 | — |
| BACK BAY A | 2,725 | 53' X 61' | 11' | 190 | 200 | — | 351 | 120 | — |
| BACK BAY B | 2,288 | 52' X 58' | 11' | 200 | 200 | — | 325 | 114 | — |
| BACK BAY C | 3,080 | 70' X 61' | 11' | 280 | 265 | — | 450 | 175 | — |
| BACK BAY D | 2,048 | 62' X 44' | 11' | 200 | 195 | — | 330 | 100 | — |
| CONSTITUTION BALLROOM | 6,403 | 117' X 57' | 13' | 600 | 600 | — | 800 | 340 | — |
| CONSTITUTION A | 3,204 | 59' X 57' | 13' | 300 | 300 | — | 400 | 153 | — |
| CONSTITUTION B | 3,199 | 59' X 57' | 13' | 300 | 300 | — | 400 | 153 | — |
| GRAND BALLROOM | 9,599 | 111' X 91' | 23' | 850 | 1,092 | — | 1,200 | 550 | — |
| GRAND PREFUNCTION | 7,500 | 123' X 63' | 14' | — | — | — | 1,000 | — | — |
| LIBERTY & GRAND | 12,040 | 120' X 111' | 12' | 1,030 | 1,250 | — | 1,440 | 660 | — |
| INDEPENDENCE & GRAND | 13,234 | 91' X 165' | 12' | 1,200 | 1,500 | — | 2,000 | 700 | — |
| REPUBLIC & GRAND 1 | 3,716 | 141' X 152' | 12' | 1,270 | 1,500 | — | 1,800 | 810 | — |
| GRAND, LIBERTY & INDEPENDENCE | 15,675 | 165' X 116' | 12' | 1,280 | 1,710 | — | 2,200 | 950 | — |
| GRAND, LIBERTY & REPUBLIC | 16,157 | 183' X 141' | 12' | 1,410 | 1,600 | — | 2,450 | 920 | — |
| GRAND, INDEPENDENCE & REPUBLIC | 17,351 | 154' X 165' | 12' | 1,550 | 1,870 | — | 2,600 | — | — |
| GRAND, INDEPENDENCE, REPUBLIC & LIBERTY | 19,792 | 182' X 165' | 12' | 1,790 | 2,100 | — | 3,000 | — | — |

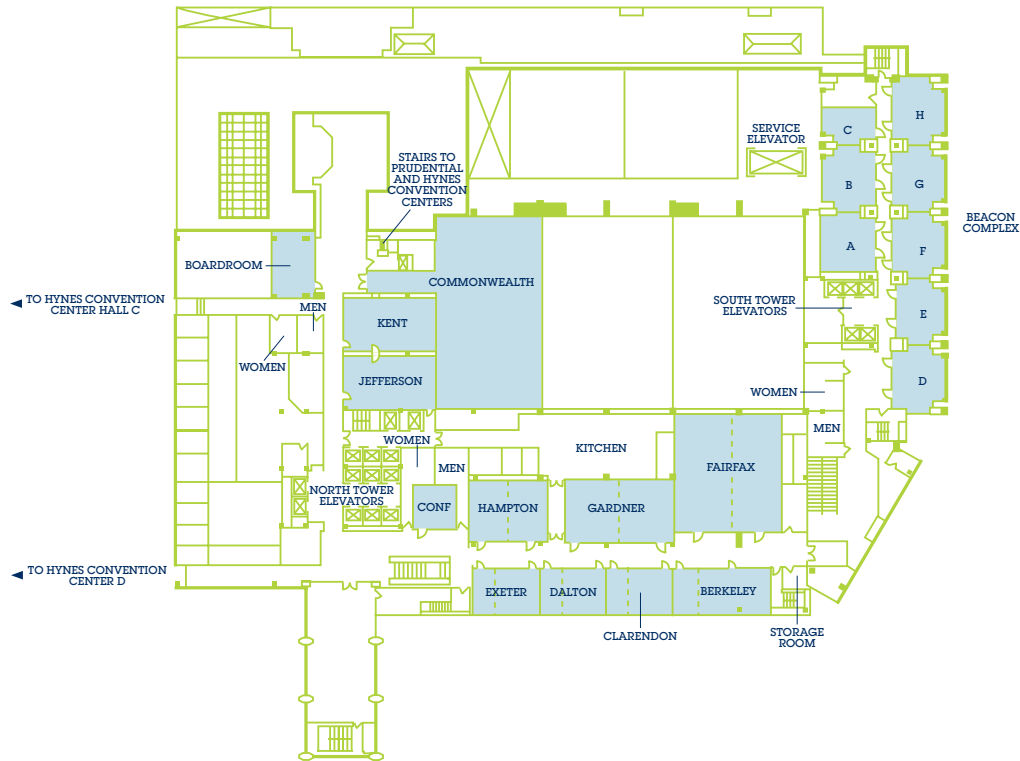

ROOM DIMENSIONS AND SEATING CAPACITY — THIRD FLOOR

| Room Name | Square Feet | Dimensions | Height | Rounds of 10 | Theater | Conference | Reception | Classroom | U-Shape |
|-----------------|-------------|------------|--------|--------------|---------|------------|-----------|-----------|---------|
| BEACON A | 616 | 27' X 24' | 8' | 50 | 54 | 25 | 75 | 27 | 23 |
| BEACON B | 603 | 30' X 24' | 8' | 40 | 54 | 25 | 75 | 27 | 24 |
| BEACON C | 190 | 16' X 12' | 8' | 20 | 20 | 12 | 15 | 15 | — |
| BEACON D | 577 | 30' X 22' | 8' | 40 | 45 | 24 | 75 | 27 | 24 |
| BEACON E | 575 | 30' X 22' | 8' | 40 | 45 | 24 | 75 | 27 | 24 |
| BEACON F | 575 | 30' X 22' | 8' | 40 | 45 | 24 | 75 | 27 | 24 |
| BEACON G | 575 | 30' X 22' | 8' | 40 | 45 | 24 | 75 | 27 | 24 |
| BEACON H | 575 | 26' X 24' | 8' | 40 | 45 | 24 | 75 | 27 | 24 |
| COMMONWEALTH | 2,817 | 55' X 48' | 9' | 180 | 250 | 50 | 250 | 150 | 52 |
| CLARENDON | 560 | 20' X 28' | 9' | 50 | 45 | 18 | 50 | 28 | 26 |
| CLARENDON A | 280 | 20' X 14' | 9' | 20 | 21 | 12 | 25 | 12 | — |
| CLARENDON B | 280 | 20' X 14' | 9' | 20 | 21 | 12 | 25 | 12 | — |
| DALTON | 588 | 20' X 28' | 9' | 50 | 45 | 18 | 50 | 28 | 26 |
| DALTON A | 295 | 20' X 14' | 9' | 20 | 21 | 12 | 25 | 12 | — |
| DALTON B | 293 | 20' X 14' | 9' | 20 | 21 | 12 | 25 | 12 | — |
| EXETER | 588 | 20' X 28' | 9' | 50 | 45 | 18 | 50 | 28 | 26 |
| EXETER A | 294 | 20' X 14' | 9' | 20 | 21 | 12 | 25 | 12 | — |
| EXETER B | 294 | 20' X 14' | 9' | 20 | 21 | 12 | 25 | 12 | — |
| BERKLEY | 846 | 20' X 40' | 9' | 70 | 75 | 36 | 100 | 40 | 30 |
| BERKLEY A | 311 | 15' X 20' | 9' | 20 | 25 | 14 | 25 | 15 | — |
| BERKLEY B | 535 | 20' X 26' | 9' | 50 | 45 | 20 | 50 | 21 | 24 |
| CONFERENCE ROOM | 372 | 20' X 18' | 9' | — | — | 10 | — | — | — |
| BOARDROOM | 395 | 27' X 13' | 8' | — | — | 12 | — | — | — |
| HAMPTON | 952 | 25' X 35' | 9' | 90 | 100 | 30 | 100 | 42 | 35 |
| HAMPTON A | 476 | 25' X 17' | 9' | 40 | 40 | 20 | 50 | 24 | 15 |
| HAMPTON B | 476 | 25' X 19' | 9' | 40 | 40 | 20 | 50 | 24 | 15 |
| KENT | 528 | 24' X 20' | 8' | 40 | 35 | 20 | 40 | 18 | 20 |
| JEFFERSON | 650 | 31' X 22' | 7' | 50 | 55 | 18 | 60 | 24 | 26 |
| GARDNER | 1,314 | 28' X 48' | 9' | 110 | 120 | 36 | 100 | 75 | 41 |
| GARDNER A | 560 | 28' X 19' | 9' | 40 | 45 | 18 | 50 | 24 | 20 |
| GARDNER B | 754 | 28' X 29' | 9' | 60 | 55 | 18 | 80 | 30 | 26 |
| FAIRFAX | 1,969 | 47' X 43' | 9' | 180 | 220 | — | 220 | 110 | 35 |
| FAIRFAX A | 1,141 | 27' X 42' | 9' | 130 | 150 | 34 | 150 | 62 | 35 |
| FAIRFAX B | 828 | 20' X 42' | 9' | 60 | 80 | 32 | 60 | 38 | 20 |